

EXISTING BUILDING TABLE					
NO.	DESCRIPTION/USE	ELEVATION	NO.	DESCRIPTION/USE	ELEVATION
1	TERMINAL BUILDING	409.61	14	HERITAGE AVIATION HANGAR	387.24
2	COVERED PARKING GARAGE	409.61	15	PRATT & WHITNEY	374.31
3	CAR WASH	352.80	16	HANGAR (VFA)	341.35
4	FAA BUILDING & ATCT	426.65	17	HEXAGON HANGARS	336.94
5	BUILDING 6	355.56	18	CONT. MAINT. HANGAR	364.81
6	NORTH HANGAR	362.23	19	ALERT HANGARS	353.81
7	FUEL FARM	-	20	NEW ASR-11 TOWER (2005)	353.82
8	BEACON SOUTH BUILDING	386.59	21	PREVIOUS ASR-9 TOWER SITE	347.16
9	HANGAR	369.32	22	PARKING CONTROL OFFICE	347.76
10	HANGAR /MAINTENANCE SHOP	359.80	23	SAND/SNOW EQUIPMENT	353.52
11	HANGAR (FEDEX)	357.94	24	AIRFIELD LIGHTING VAULT	339.13
12	HANGAR (ASH)	375.01	25	T-HANGAR	348.55
13	HANGER (AVIATRON)	346.97			

PROPOSED BUILDING TABLE					
NO.	DESCRIPTION/USE	ELEVATION	NO.	DESCRIPTION/USE	ELEVATION
30	SRE BUILDING	467.00	43	CONV. HANGAR	482.00
31	CONV. HANGAR	388.00	44	CONV. HANGAR	482.00
32	CONV. HANGAR	385.00	45	CONV. HANGAR	482.00
33	CONV. HANGAR	385.00			
34	CONV. HANGAR	385.00			
35	CONV. HANGAR	385.00			
36	CONV. HANGAR	385.00			
37	CONV. HANGAR	385.00			
38	CONV. HANGAR	472.00			
39	CONV. HANGAR	488.00			
40	CONV. HANGAR	482.00			
41	CONV. HANGAR	482.00			
42	CONV. HANGAR	482.00			

LEGEND		
DESCRIPTION	EXISTING	PROPOSED
RUNWAY SAFETY AREA (RSA)	RSA	RSA
RUNWAY OBJECT FREE AREA (ROFA)	ROFA	ROFA
TAXIWAY SAFETY AREA (RSA)	TSA	TSA
TAXIWAY OBJECT FREE AREA (ROFA)	TOFA	TOFA
AIRPORT PROPERTY LINE	EAPL	FAPL
EXISTING BUILDINGS	[Hatched Box]	[Hatched Box]
BUILDING RESTRICTION LINE (BRL)	BRL	BRL
EXISTING FENCE (8' HEIGHT)	X-X	X-X
PAVEMENT	[Hatched Box]	[Hatched Box]
REMOVE PAVEMENT	N/A	[Hatched Box]

BUILDING ELEVATIONS FROM AERIAL PHOTOGRAPHY

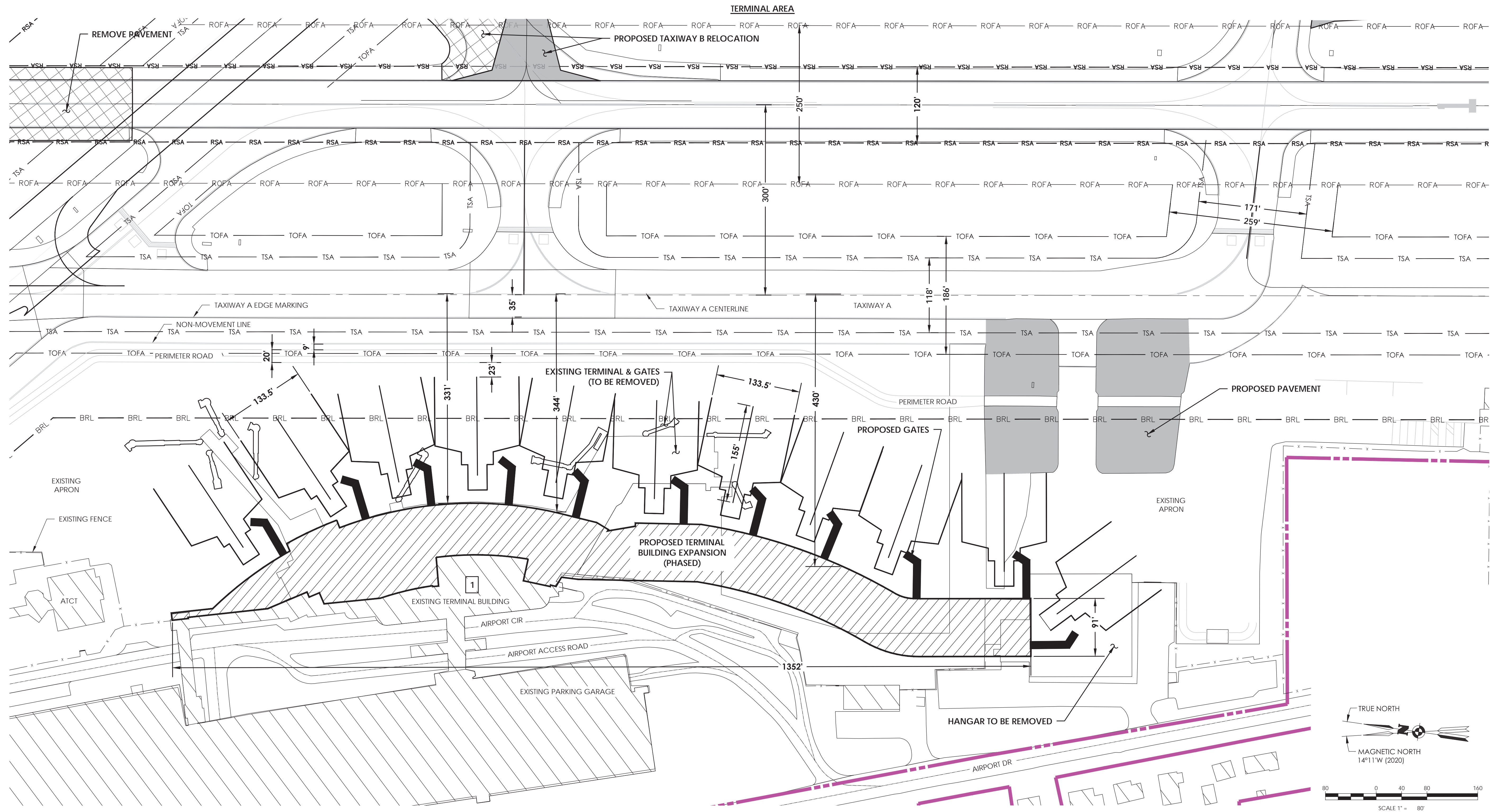

Stamp:
Client:
BURLINGTON INTERNATIONAL AIRPORT
1200 Airport Drive
South Burlington, VT 05403

Passero Associates
242 W. Main Street
Rochester, NY 14614
(585) 325-1000
Fax: (585) 325-1691
Principal-in-Charge: Andrew Holesko
Project Manager: Lisa Chueng
Designed by: Wayne Zian

Revisions			
No.	Date	By	Description

UNAUTHORIZED ALTERATIONS OR ADDITIONS TO THIS DRAWING IS IN VIOLATION OF STATE EDUCATION LAW ARTICLE 145 SECTION 7309 AND ARTICLE 147 SECTION 7307. THESE PLANS ARE COPYRIGHT PROTECTED ©

Terminal Plan

Airport Layout Plan Update
Burlington International Airport (BTV)

Town/City: South Burlington
County: CHITTENDEN State: Vermont
Project No. 20150403.0002
Drawing No. 5A
Date January 2021

EXISTING BUILDING TABLE					
NO.	DESCRIPTION/USE	ELEVATION	NO.	DESCRIPTION/USE	ELEVATION
1	TERMINAL BUILDING	409.61	14	HERITAGE AVIATION HANGAR	387.24
2	COVERED PARKING GARAGE	409.61	15	PRATT & WHITNEY	374.31
3	CAR WASH	352.80	16	HANGAR (VFA)	341.35
4	FAA BUILDING & ATCT	426.65	17	HEXAGON HANGARS	336.94
5	BUILDING 6	355.56	18	CONT. MAINT. HANGAR	364.81
6	NORTH HANGAR	362.23	19	ALERT HANGARS	353.81
7	FUEL FARM	-	20	NEW ASR-11 TOWER (2005)	353.82
8	BEACON SOUTH BUILDING	386.59	21	PREVIOUS ASR-9 TOWER SITE	347.16
9	HANGER	369.32	22	PARKING CONTROL OFFICE	347.76
10	HANGAR / MAINTENANCE SHOP	359.80	23	SAND/SNOW EQUIPMENT	353.52
11	HANGAR (FEDEX)	357.94	24	AIRFIELD LIGHTING VAULT	339.13
12	HANGAR (ASH)	375.01	25	T-HANGAR	348.55
13	HANGER (AVIATION)	346.97			

PROPOSED BUILDING TABLE					
NO.	DESCRIPTION/USE	ELEVATION	NO.	DESCRIPTION/USE	ELEVATION
30	SRE BUILDING	467.00	43	HANGAR	482.00
31	HANGAR	388.00	44	HANGAR	482.00
32	HANGAR	385.00	45	HANGAR	482.00
33	HANGAR	385.00			
34	HANGAR	385.00			
35	HANGAR	385.00			
36	HANGAR	385.00			
37	HANGAR	385.00			
38	HANGAR	472.00			
39	HANGAR	488.00			
40	HANGAR	482.00			
41	HANGAR	482.00			
42	HANGAR	482.00			

LEGEND		
DESCRIPTION	EXISTING	PROPOSED
RUNWAY SAFETY AREA (RSA)	— RSA —	— RSA —
RUNWAY OBJECT FREE AREA (ROFA)	— ROFA —	— ROFA —
TAXIWAY SAFETY AREA (TSA)	— TSA —	— TSA —
TAXIWAY OBJECT FREE AREA (TOFA)	— TOFA —	— TOFA —
AIRPORT PROPERTY LINE	— EAPL —	— FAPL —
EXISTING BUILDINGS	▨	▨
BUILDING RESTRICTION LINE (BRL)	— BRL —	— BRL —
EXISTING FENCE (8' HEIGHT)	— X — X —	— X — X —
PAVEMENT		▨
REMOVE PAVEMENT	N/A	▨

BUILDING ELEVATIONS FROM AERIAL PHOTOGRAPHY

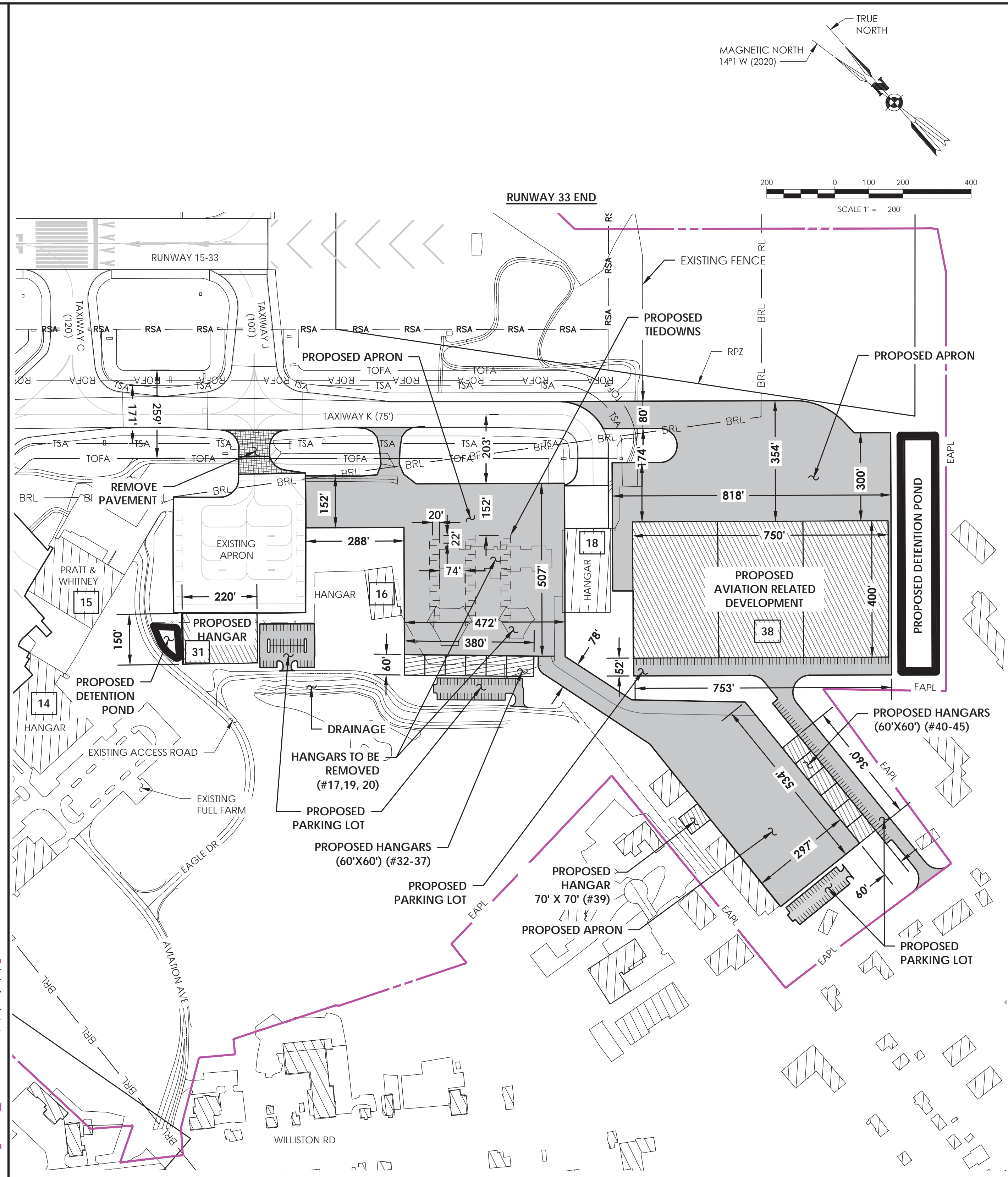
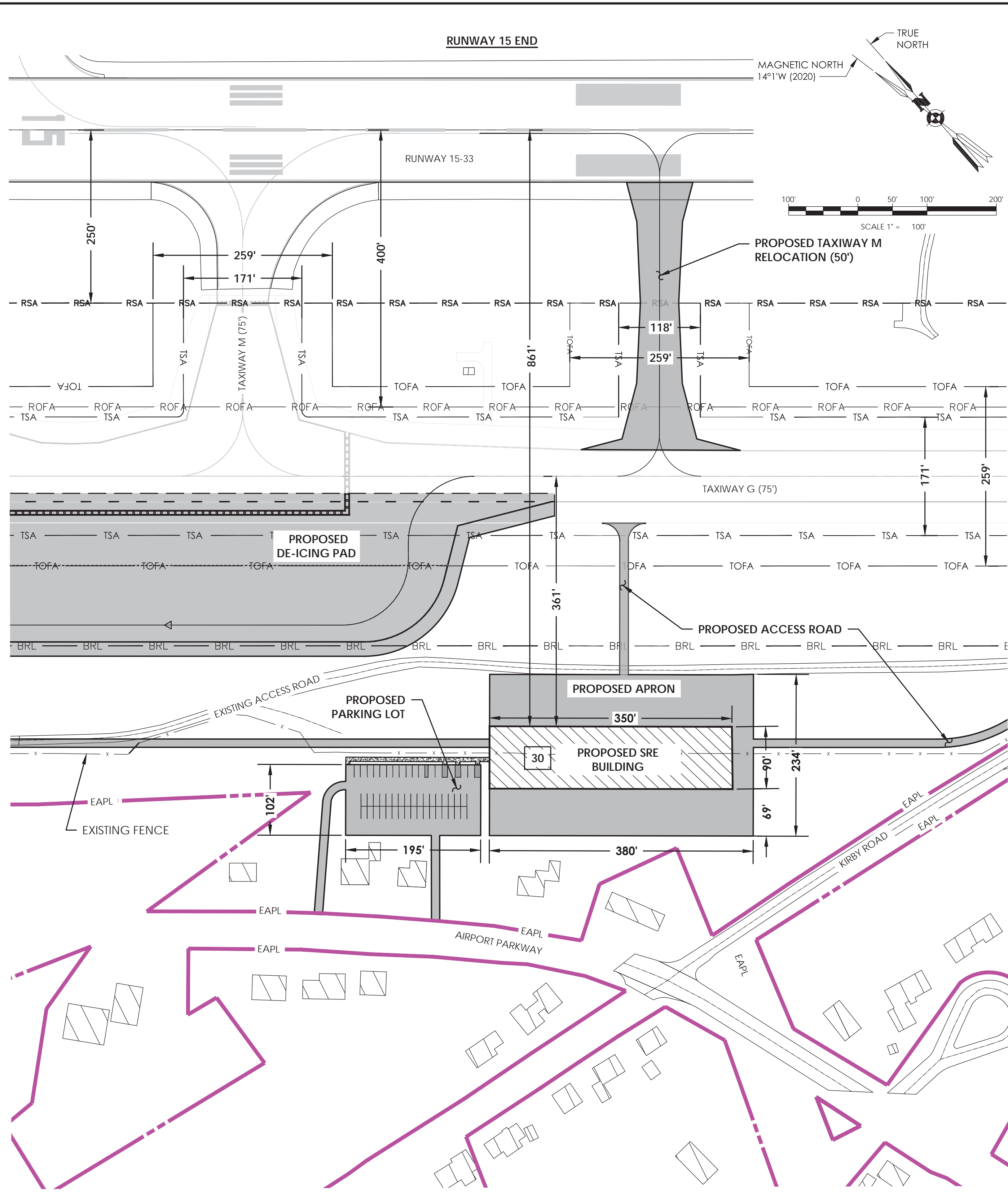

Client:
BURLINGTON INTERNATIONAL AIRPORT
1200 Airport Drive
South Burlington, VT 05403

Passero Associates
242 W. Main Street
Rochester, NY 14614
(585) 325-1000
Fax: (585) 325-1691
Principal-in-Charge: Andrew Holesko
Project Manager: Lisa Chueng
Designed by: Wayne Zian

Revisions			
No.	Date	By	Description

UNAUTHORIZED ALTERATIONS OR ADDITIONS TO THIS DRAWING IS IN VIOLATION OF STATE EDUCATION LAW ARTICLE 145 SECTION 7309 AND ARTICLE 147 SECTION 7307. THESE PLANS ARE COPYRIGHT PROTECTED ©

Terminal Plan

Airport Layout Plan Update
Burlington International Airport (BTV)
Town/City: South Burlington
County: CHITTENDEN State: Vermont
Project No. 20150403.0002
Drawing No. 5B
Date January 2021