

Stamp:

Client:
BURLINGTON INTERNATIONAL AIRPORT
 1200 Airport Drive
 South Burlington, VT 05403

Passero Associates
 242 W. Main Street (585) 325-1000
 Rochester, NY 14614 Fax: (585) 325-1691
 Principal-in-Charge Andrew Holesko
 Project Manager Lisa Chueng
 Designed by Wayne Zian

Revisions			
No.	Date	By	Description

UNAUTHORIZED ALTERATIONS OR ADDITIONS TO THIS DRAWING IS IN VIOLATION OF STATE EDUCATION LAW ARTICLE 145 SECTION 7309 AND ARTICLE 147 SECTION 7307. THESE PLANS ARE COPYRIGHT PROTECTED ©

Inner Portion of Runway 15 Approach Surface (Plan)
 Airport Layout Plan Update
Burlington International Airport (BTV)
 Town/City: South Burlington
 County: CHITTENDEN State: Vermont
 Project No. 20150403.0002
 Drawing No. 7A
 Date January 2021

- LEGEND:**
- AIRPORT PROPERTY LINE
 - EXISTING RPZ
 - OBSTRUCTION
 - TREE CLUSTER

	FROM RUNWAY END	INNER WIDTH	OUTER WIDTH	DISTANCE	SLOPE
PART 77	200'	1000'	4,000'	10,000'	50:1

	FROM RUNWAY END	INNER WIDTH	OUTER WIDTH	DISTANCE	SLOPE
TYPE 5 RES	200'	800'	3,400'	10,000'	34:1

	FROM RUNWAY END	INNER WIDTH	OUTER WIDTH	DISTANCE	SLOPE
TYPE 6 GQS	0'	350'	1,520'	10,000'	30:1

NOTES:

- OBSTACLE DATA SOURCE, WOOLPERT SURVEY, 2019.
- "ALL OBJECT ELEVATIONS ARE CURRENT AS OF THIS ALP UPDATE AND ARE SUBJECT TO CHANGE."
- RES VISIBILITY LESS THAN 3/4 MILE, BASED ON EB99, TABLE 3-2, TYPE 4. GQS BASED ON EB99, TABLE 3-2, TYPE 6.

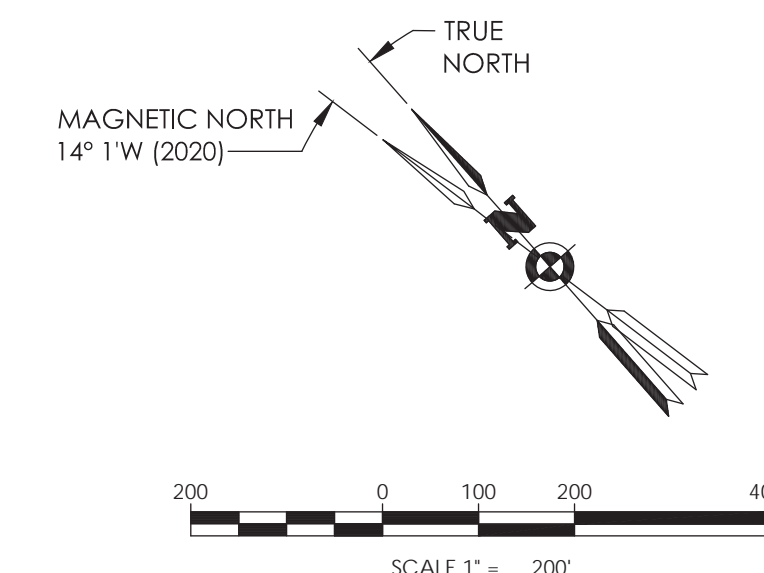

NOTES:

1. OBSTACLE DATA SOURCE, WOOLPERT SURVEY, 2019.
2. "ALL OBJECT ELEVATIONS ARE CURRENT AS OF THIS ALP UPDATE AND ARE SUBJECT TO CHANGE."
3. RES VISIBILITY LESS THAN 3/4 MILE PER EB99, TABLE 3-2, TYPE 5. GQS BASED ON EB99, TABLE 3-2, TYPE 6.

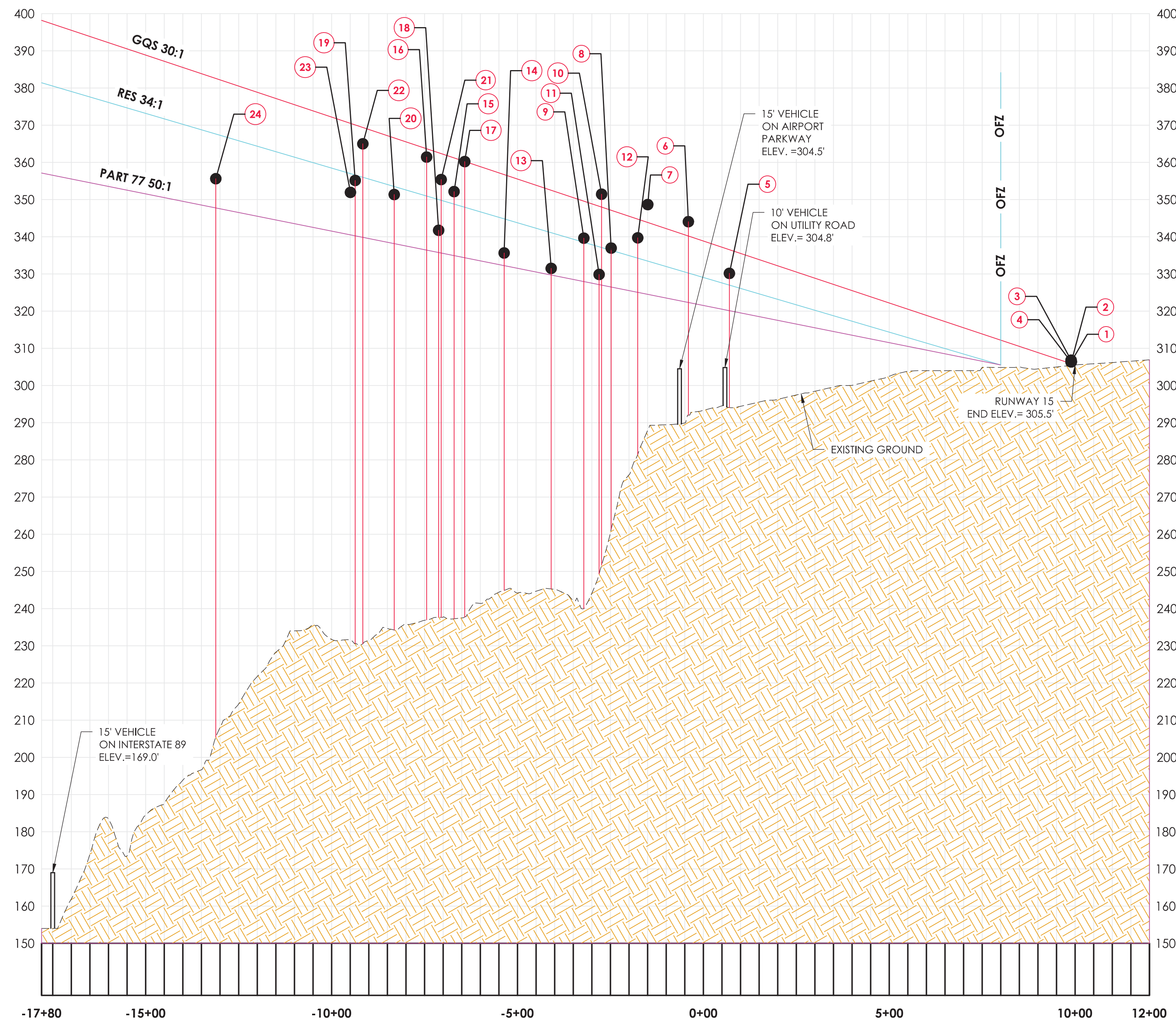

RUNWAY 15 PROFILE
SCALE: HORIZONTAL - 1" = 200'
VERTICAL - 1" = 10'

PART 77 SURFACE

ID	DESCRIPTION	OBJECT ELEVATION	SURFACE HEIGHT ALLOWED	50:1 P77 PENETRATION	ON/OFF AIRPORT	DISPOSITION
5	TREE	330.2	320.1	10.1	ON	TRIMMED OR REMOVED
6	TREE	344.1	322.3	21.8	OFF	TRIMMED OR REMOVED
7	TREE	348.7	324.5	24.2	OFF	TRIMMED OR REMOVED
8	TREE	337	326.5	10.5	OFF	TRIMMED OR REMOVED
9	TREE	339.6	328.0	11.6	OFF	TRIMMED OR REMOVED
10	TREE	351.4	327.0	24.4	OFF	TRIMMED OR REMOVED
11	TREE	329.9	327.1	2.8	OFF	TRIMMED OR REMOVED
12	TREE	339.7	325.1	14.6	OFF	TRIMMED OR REMOVED
13	TREE	331.5	329.7	1.8	OFF	TRIMMED OR REMOVED
14	TREE	335.6	332.2	3.4	ON	TRIMMED OR REMOVED
15	TREE	352.2	334.9	17.3	OFF	TRIMMED OR REMOVED
16	TREE	361.4	336.4	25	OFF	TRIMMED OR REMOVED
17	TREE GROUP	360.2	334.4	25.8	OFF	TRIMMED OR REMOVED
18	TREE GROUP	341.7	335.8	5.9	OFF	TRIMMED OR REMOVED
19	TREE GROUP	355.2	340.3	14.9	ON/OFF	TRIMMED OR REMOVED
20	TREE GROUP	351.4	338.2	13.2	OFF	TRIMMED OR REMOVED
21	TREE	355.4	335.6	19.8	OFF	TRIMMED OR REMOVED
22	TREE	365	365.0	0	OFF	TRIMMED OR REMOVED
23	TREE	351.9	340.5	11.4	OFF	TRIMMED OR REMOVED
24	TREE GROUP	355.6	355.6	0	OFF	TRIMMED OR REMOVED

RES SURFACE (TYPE 5)

ID	DESCRIPTION	OBJECT ELEVATION	SURFACE HEIGHT ALLOWED	34:1 RES PENETRATION	ON/OFF AIRPORT	DISPOSITION
9	TREE	339.6	338.5	1.1	OFF	TRIMMED OR REMOVED
10	TREE	351.4	337.1	14.3	OFF	TRIMMED OR REMOVED
16	TREE	361.4	350.9	10.5	OFF	TRIMMED OR REMOVED
17	TREE GROUP	360.2	347.9	12.3	OFF	TRIMMED OR REMOVED
21	TREE	355.4	349.7	5.7	OFF	TRIMMED OR REMOVED

GQS SURFACE (TYPE 6)

ID	DESCRIPTION	OBJECT ELEVATION	SURFACE HEIGHT ALLOWED	30:1 GQS Surface Penetration	ON/OFF AIRPORT	DISPOSITION
1	LIGHT	306.4	305.9	0.5	ON	FIXED BY FUNCTION
2	LIGHT	306.4	305.9	0.5	ON	FIXED BY FUNCTION
3	LIGHT GROUP	306.8	305.9	0.9	ON	FIXED BY FUNCTION
4	LIGHT GROUP	306.4	305.9	0.5	ON	FIXED BY FUNCTION

OFZ PENETRATIONS ARE LIGHTS FIXED BY FUNCTION



Stamp:

Client:
BURLINGTON INTERNATIONAL AIRPORT
1200 Airport Drive
South Burlington, VT 05403

Passero Associates
242 W. Main Street Rochester, NY 14614 (585) 325-1000 Fax: (585) 325-1691
Principal-in-Charge Andrew Holesko
Project Manager Lisa Chueng
Designed by Wayne Zian

Revisions

No.	Date	By	Description

UNAUTHORIZED ALTERATIONS OR ADDITIONS TO THIS DRAWING IS IN VIOLATION OF STATE EDUCATION LAW ARTICLE 145 SECTION 7309 AND ARTICLE 141 SECTION 7307. THESE PLANS ARE COPYRIGHT PROTECTED ©

Inner Portion of Runway 15 Approach Surface Profile (Profile)
Airport Layout Plan Update
Burlington International Airport (BTV)
Town/City: South Burlington
County: CHITTENDEN State: Vermont
Project No. 20150403.0002
Drawing No. 7B
Date January 2021

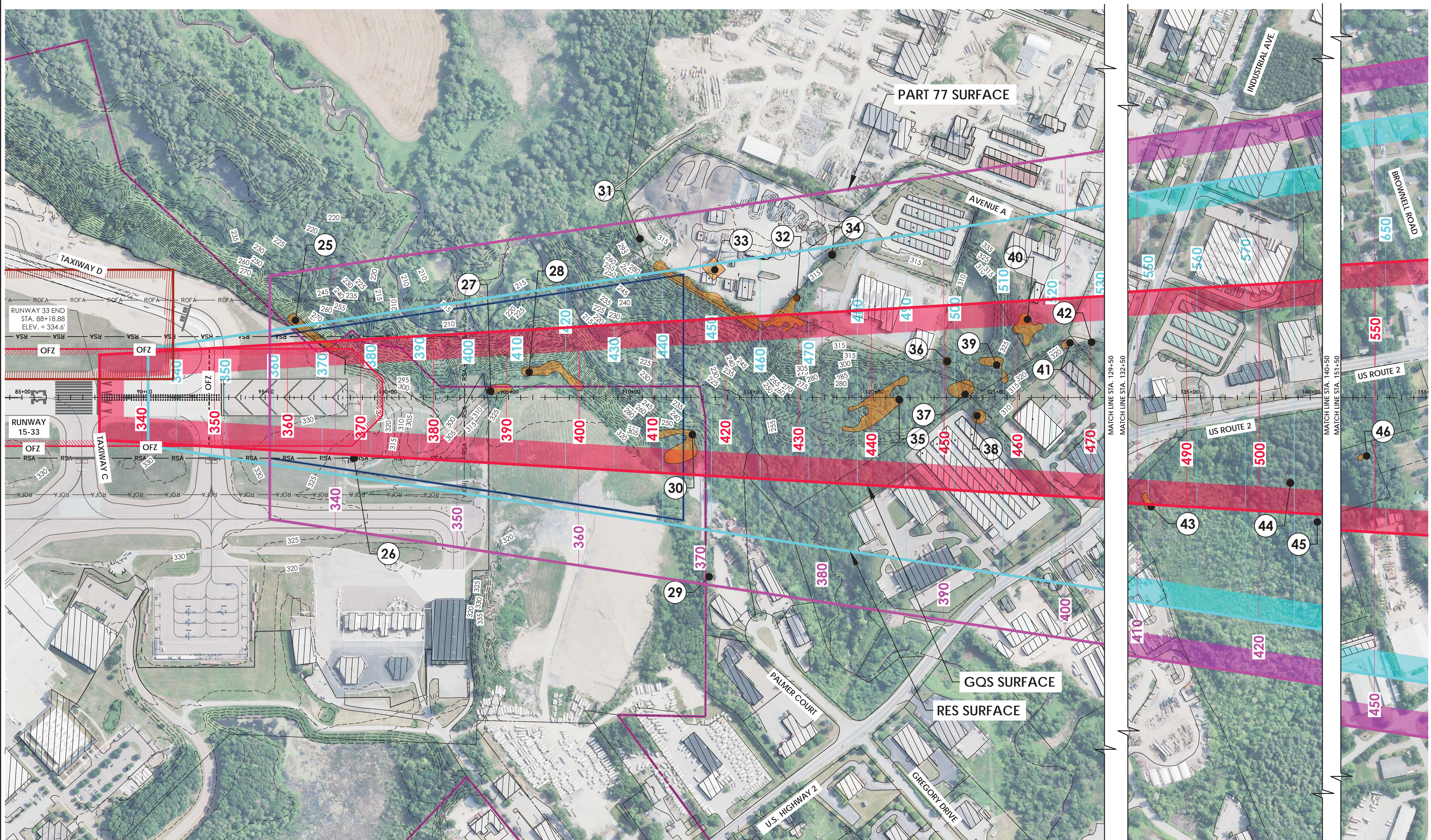

LEGEND:

-  AIRPORT PROPERTY LINE
-  EXISTING RPZ
-  OBSTRUCTION
-  TREE CLUSTER

	FROM RUNWAY END	INNER WIDTH	OUTER WIDTH	DISTANCE	SLOPE
PART 77	200'	1000'	4,000'	10,000'	50:1

TYPE 4	FROM RUNWAY END	INNER WIDTH	OUTER WIDTH	DISTANCE	SLOPE
RES	200'	400'	3,400'	10,000'	20:1

TYPE 6	FROM RUNWAY END	INNER WIDTH	OUTER WIDTH	DISTANCE	SLOPE
GQS	0'	350'	1,520'	10,000'	30:1

NOTES:

1. OBSTACLE DATA SOURCE, WOOLPERT SURVEY, 2019.
2. "ALL OBJECT ELEVATIONS ARE CURRENT AS OF THIS ALP UPDATE AND ARE SUBJECT TO CHANGE."
3. RES AND GQS BASED ON EB99, TABLE 3-2, TYPE 4 AND 6 RESPECTIVELY.

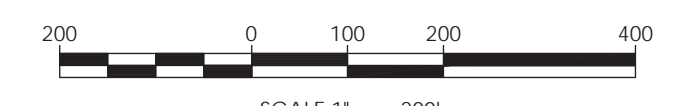
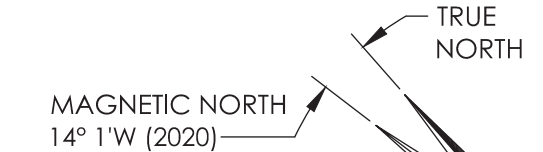

Stamp:

--	--	--

Client:
BURLINGTON INTERNATIONAL AIRPORT
1200 Airport Drive
South Burlington, VT 05403

Passero Associates
242 W. Main Street
Rochester, NY 14614
Project Manager: Lisa Chueng
Principal-in-Charge: Andrew Holesko
Designed by: Lisa Chueng, Wayne Zian

Revisions

No.	Date	By	Description

UNAUTHORIZED ALTERATIONS OR ADDITIONS TO THIS DRAWING IS IN VIOLATION OF STATE EDUCATION LAW ARTICLE 145 SECTION 7309 AND ARTICLE 147 SECTION 7307. THESE PLANS ARE COPYRIGHT PROTECTED ©

Inner Portion of Runway 33 Approach Surface (Plan)

Airport Layout Plan Update
Burlington International Airport (BTV)
Town/City: South Burlington
County: CHITTENDEN State: Vermont
Project No. 20150403.0002
Drawing No. 8A
Date January 2021

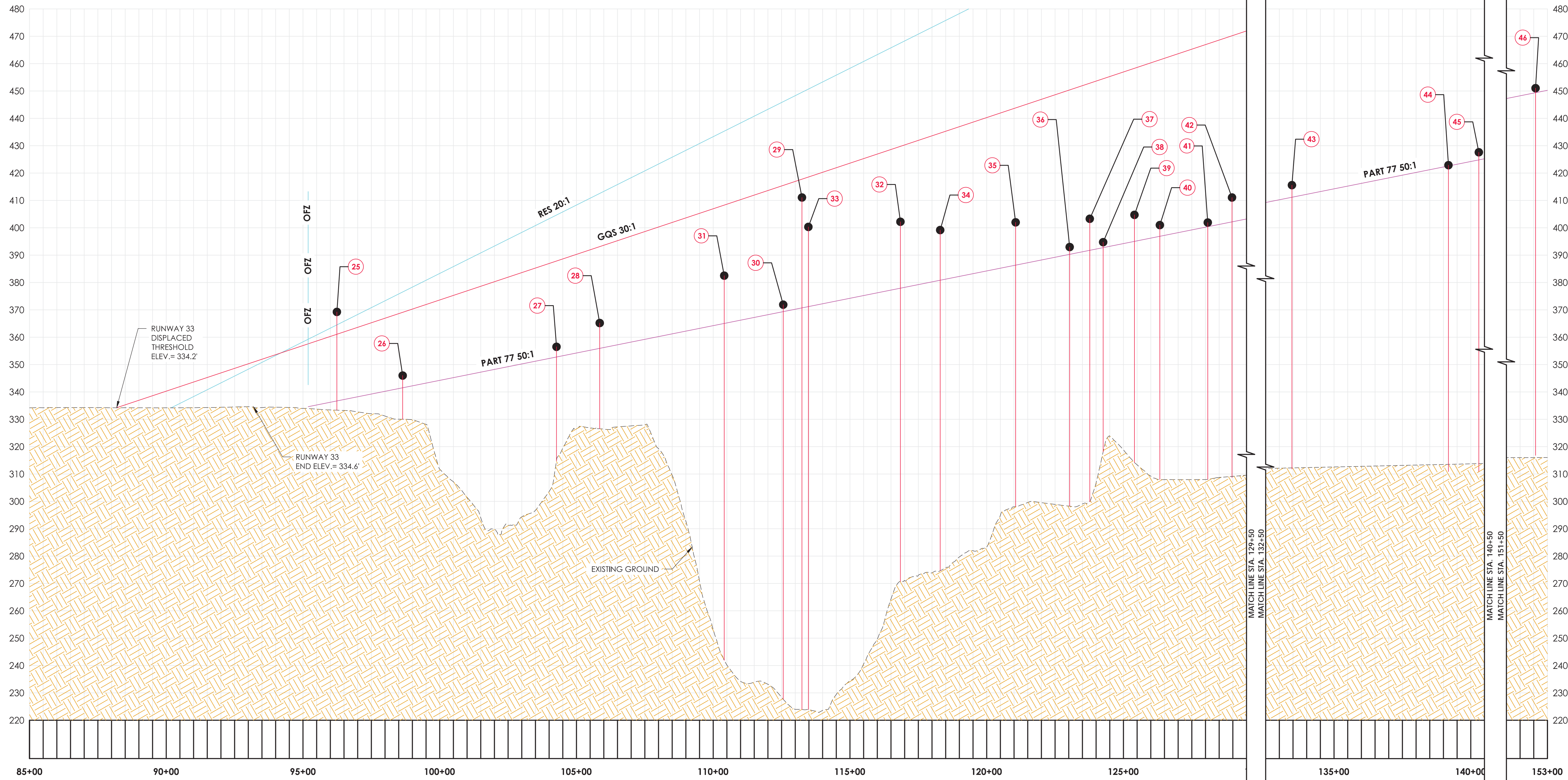

RUNWAY 33 PROFILE

SCALE: HORIZONTAL - 1" = 200'
VERTICAL - 1" = 10'

PART 77 SURFACE

ID	DESCRIPTION	OBJECT ELEVATION	SURFACE HEIGHT ALLOWED	50:1 P77 PENETRATION	ON/OFF AIRPORT	DISPOSITION
25	TREE GROUP	369.3	336.7	32.6	ON/OFF	TRIM OR REMOVE
26	NAVAID	346	341.5	4.5	ON	FIXED BY FUNCTION
27	TREE GROUP	356.5	352.8	3.7	ON	TRIM OR REMOVE
28	TREE GROUP	365.2	355.9	9.3	ON/OFF	TRIM OR REMOVE
29	TREE	411.1	370.7	40.4	OFF	TRIM OR REMOVE
30	TREE GROUP	371.9	369.4	2.5	ON	TRIM OR REMOVE
31	TREE	382.5	365.1	17.4	OFF	TRIM OR REMOVE
32	TREE GROUP	402.2	377.9	24.3	OFF	TRIM OR REMOVE
33	ELEVATOR	400.3	371.2	29.1	OFF	TRIM OR REMOVE
34	TREE	399.2	380.8	18.4	OFF	TRIM OR REMOVE
35	TREE GROUP	402	386.3	15.7	OFF	TRIM OR REMOVE
36	TREE	393	390.3	2.7	OFF	TRIM OR REMOVE
37	TREE GROUP	403.3	391.8	11.5	OFF	TRIM OR REMOVE
38	TREE GROUP	394.7	392.7	2	OFF	TRIM OR REMOVE
39	TREE GROUP	404.2	394.4	9.8	OFF	TRIM OR REMOVE
40	TREE GROUP	401	396.9	4.1	OFF	TRIM OR REMOVE
41	TREE GROUP	401.9	400.4	1.5	OFF	TRIM OR REMOVE
42	TREE	411.1	402.2	8.9	OFF	TRIM OR REMOVE
43	TREE GROUP	415.6	411.2	4.4	OFF	TRIM OR REMOVE
44	TREE	422.9	422.6	0.3	OFF	TRIM OR REMOVE
45	TREE	427.6	424.8	2.8	OFF	TRIM OR REMOVE
46	TREE GROUP	451	449.4	1.6	OFF	TRIM OR REMOVE

RES SURFACE (TYPE 4)

ID	DESCRIPTION	OBJECT ELEVATION	SURFACE HEIGHT ALLOWED	20:1 RES PENETRATION	ON/OFF AIRPORT	DISPOSITION
25	TREE GROUP	369.3	365.6	3.7	OFF	TRIM AND REMOVE

GQS SURFACE NO PENETRATIONS (TYPE 6)

NOTES:

1. OBSTACLE DATA SOURCE, WOOLPERT SURVEY, 2019.
2. "ALL OBJECT ELEVATIONS ARE CURRENT AS OF THIS ALP UPDATE AND ARE SUBJECT TO CHANGE."
3. RES AND GQS BASED ON EB99, TABLE 3-2, TYPE 4 AND 6 RESPECTIVELY.



Stamp:
Client:
BURLINGTON INTERNATIONAL AIRPORT
1200 Airport Drive
South Burlington, VT 05403
Passero Associates
242 W. Main Street
Rochester, NY 14614
(585) 325-1000
Fax: (585) 325-1691
Principal-in-Charge: Andrew Holesko
Project Manager: Lisa Chueng
Designed by: Wayne Zian

Revisions

No.	Date	By	Description

UNAUTHORIZED ALTERATIONS OR ADDITIONS TO THIS DRAWING IS IN VIOLATION OF STATE EDUCATION LAW ARTICLE 145 SECTION 7309 AND ARTICLE 141 SECTION 7307. THESE PLANS ARE COPYRIGHT PROTECTED. ©

Inner Portion of Runway 33 Approach Surface (Profile)
Airport Layout Plan Update
Burlington International Airport (BTV)
Town/City: South Burlington
County: CHITTENDEN State: Vermont
Project No. 20150403.0002
Drawing No. 8B
Date January 2021



Stamp:

Client:
BURLINGTON INTERNATIONAL AIRPORT
1200 Airport Drive
South Burlington, VT 05403

Passero Associates
242 W. Main Street (585) 325-1000
Rochester, NY 14614 Fax: (585) 325-1691
Principal-in-Charge Andrew Holesko
Project Manager Lisa Chueng
Designed by Wayne Zian

Revisions			
No.	Date	By	Description

UNAUTHORIZED ALTERATIONS OR ADDITIONS TO THIS DRAWING IS IN VIOLATION OF STATE EDUCATION LAW ARTICLE 145 SECTION 7309 AND ARTICLE 141 SECTION 7307. THESE PLANS ARE COPYRIGHT PROTECTED ©

Existing Inner Portion
of Runway 1
Approach Surface
(Profile)
Airport Layout Plan Update
Burlington International Airport (BTV)
Town/City: South Burlington
County: CHITTENDEN State: Vermont

Project No.
20150403.0002

Drawing No.
9B

Date
January 2021

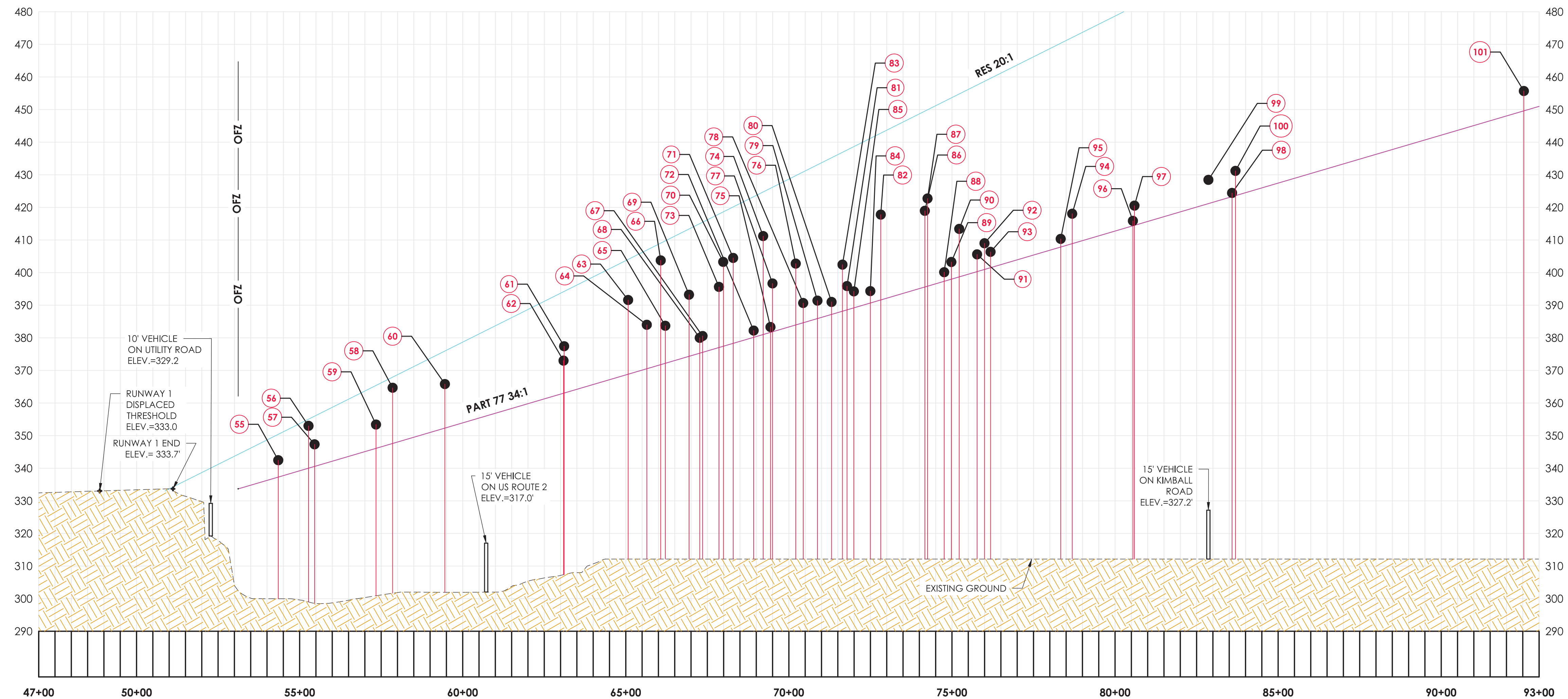

RUNWAY 1 PROFILE

SCALE: HORIZONTAL - 1" = 200'
VERTICAL - 1" = 10'

PART 77 SURFACE

ID	DESCRIPTION	OBJECT ELEVATION	SURFACE HEIGHT ALLOWED	34:1 P77 PENETRATION	ON/OFF AIRPORT	DISPOSITION
55	TREE	342.5	337.3	5.2	ON/OFF AIRPORT	TRIM OR REMOVE
56	TREE GROUP	353	340.0	13	OFF	TRIM OR REMOVE
57	TREE	347.3	340.5	6.8	OFF	TRIM OR REMOVE
58	TREE GROUP	364.7	347.6	17.1	OFF	TRIM OR REMOVE
59	TREE GROUP	353.41	346.1	7.31	OFF	TRIM OR REMOVE
60	TREE GROUP	365.8	352.3	13.5	OFF	TRIM OR REMOVE
61	TREE	377.4	363.1	14.3	OFF	TRIM OR REMOVE
62	TREE	373	363.0	10	OFF	TRIM OR REMOVE
63	TREE	391.6	368.8	22.8	OFF	TRIM OR REMOVE
64	TREE	383.9	370.5	13.4	OFF	TRIM OR REMOVE
65	TREE GROUP	383.7	372.2	11.5	OFF	TRIM OR REMOVE
66	TREE GROUP	403.7	371.8	31.9	OFF	TRIM OR REMOVE
67	TREE	380.55	375.5	5.05	OFF	TRIM OR REMOVE
68	TREE GROUP	380	375.3	4.7	OFF	TRIM OR REMOVE
69	TREE	393.2	374.3	18.9	OFF	TRIM OR REMOVE
70	TREE GROUP	403.3	377.4	25.9	OFF	TRIM OR REMOVE
71	TREE	401	378.3	22.7	OFF	TRIM OR REMOVE
72	TREE	382.2	380.1	2.1	OFF	TRIM OR REMOVE
73	TREE GROUP	395.6	377.0	18.6	OFF	TRIM OR REMOVE
74	TREE GROUP	411.2	381.1	30.1	OFF	TRIM OR REMOVE
75	TREE	383.3	381.7	1.6	OFF	TRIM OR REMOVE
76	TREE	402.8	383.9	18.9	OFF	TRIM OR REMOVE
77	TREE	396.7	381.8	14.9	OFF	TRIM OR REMOVE
78	TREE	390.7	384.6	6.1	OFF	TRIM OR REMOVE
79	TREE	391.4	385.9	5.5	OFF	TRIM OR REMOVE

80	TREE	391	387.2	3.8	OFF	TRIM OR REMOVE
81	TREE	395.9	388.6	7.3	OFF	TRIM OR REMOVE
82	TREE GROUP	417.78	391.6	26.18	OFF	TRIM OR REMOVE
83	TREE GROUP	402.4	402.5	-0.1	OFF	TRIM OR REMOVE
84	TREE GROUP	394.3	390.7	3.6	OFF	TRIM OR REMOVE
85	TREE GROUP	394.3	389.2	5.1	OFF	TRIM OR REMOVE
86	TREE	418.9	395.6	23.3	OFF	TRIM OR REMOVE
87	TREE GROUP	422.7	395.8	26.9	OFF	TRIM OR REMOVE
88	TREE GROUP	400.1	397.3	2.8	OFF	TRIM OR REMOVE
89	TREE GROUP	403.3	398.0	5.3	OFF	TRIM OR REMOVE
90	TREE GROUP	413.4	398.7	14.7	OFF	TRIM OR REMOVE
91	TREE	405.6	400.3	5.3	OFF	TRIM OR REMOVE
92	TREE GROUP	409	401.0	8	OFF	TRIM OR REMOVE
93	TREE	406.4	401.5	4.9	OFF	TRIM OR REMOVE
94	TREE	418.1	409.0	9.1	OFF	TRIM OR REMOVE
95	TREE	410.4	407.8	2.6	OFF	TRIM OR REMOVE
96	TREE	415	414.2	0.8	OFF	TRIM OR REMOVE
97	TREE	420.5	414.5	6	OFF	TRIM OR REMOVE
98	TREE GROUP	424.4	423.3	1.1	OFF	TRIM OR REMOVE
99	TREE	428.5	421.4	7.1	OFF	TRIM OR REMOVE
100	TREE	431.2	423.6	7.6	OFF	TRIM OR REMOVE
101	TREE GROUP	455.7	449.6	6.1	OFF	TRIM OR REMOVE

RES SURFACE
NO PENETRATIONS.
POINT #56, #58, #66 SHOULD BE
CONSIDERED FOR REMOVAL,
CLOSE TO THE SURFACE.

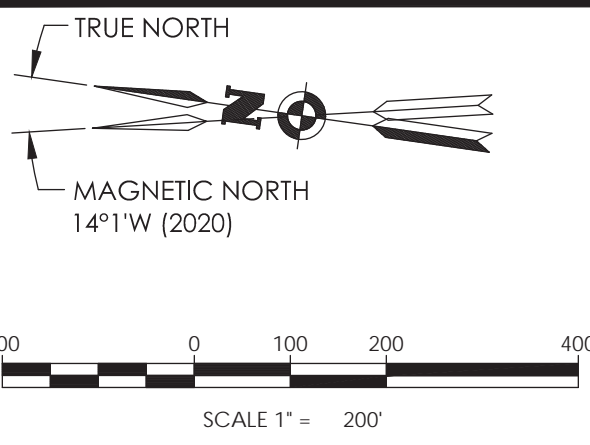

NOTES:

1. OBSTACLE DATA SOURCE, WOOLPERT SURVEY, 2019.
2. "ALL OBJECT ELEVATIONS ARE CURRENT AS OF THIS ALP UPDATE AND ARE SUBJECT TO CHANGE."
3. RES BASED EB99, TABLE 3-2, TYPE 2.

PART 77 SURFACE

	FROM RUNWAY END	INNER WIDTH	OUTER WIDTH	DISTANCE	SLOPE
PART 77	200'	500'	1,500'	5000'	20:1

ID	DESCRIPTION	OBJECT ELEVATION	SURFACE HEIGHT ALLOWED	20:1 P77 PENETRATION	ON/OFF AIRPORT	DISPOSITION
49	TREE GROUP	405.8	384.7	21.1	ON	TRIM OR REMOVE
50	TREE	386.8	386.0	0.8	ON	TRIM OR REMOVE
51	TREE	393.1	389.8	3.3	OFF	TRIM OR REMOVE
52	TREE	395.6	393.9	1.7	OFF	TRIM OR REMOVE
53	TREE	400.2	398.1	2.1	OFF	TRIM OR REMOVE
54	TREE	403	401.9	1.1	OFF	TRIM OR REMOVE

RES SURFACE

TYPE 2	FROM RUNWAY END	INNER WIDTH	OUTER WIDTH	START DISTANCE	END DISTANCE	SLOPE
RES	0'	250'	700'	2,250'	2,750'	20:1

ID	DESCRIPTION	OBJECT ELEVATION	SURFACE HEIGHT ALLOWED	20:1 RES PENETRATION	ON/OFF AIRPORT	DISPOSITION
47	LIGHT	329.6	329.4	0.2	ON	FIXED BY FUNCTION
48	LIGHT GROUP	329.4	329.3	0.1	ON	FIXED BY FUNCTION

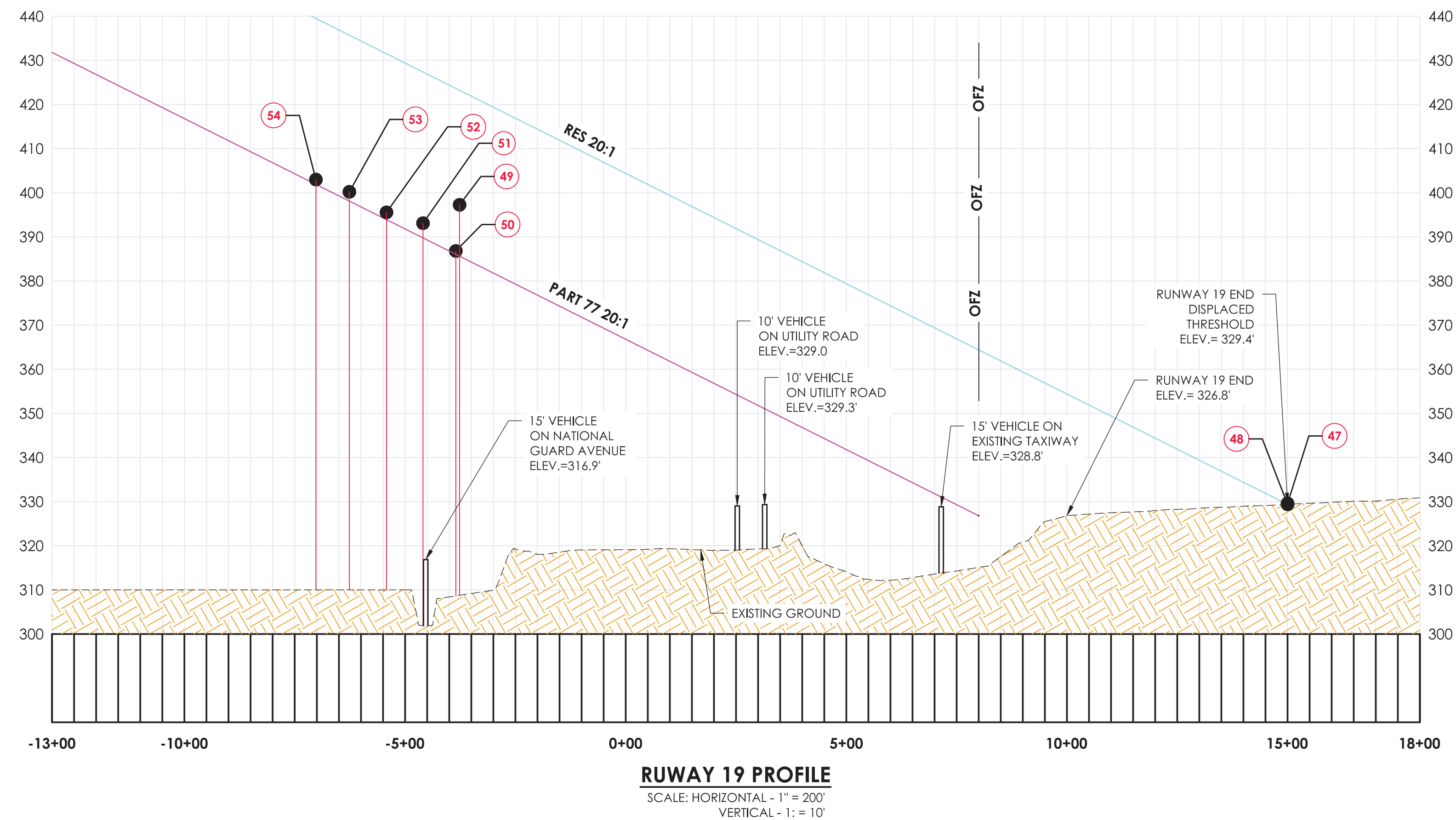
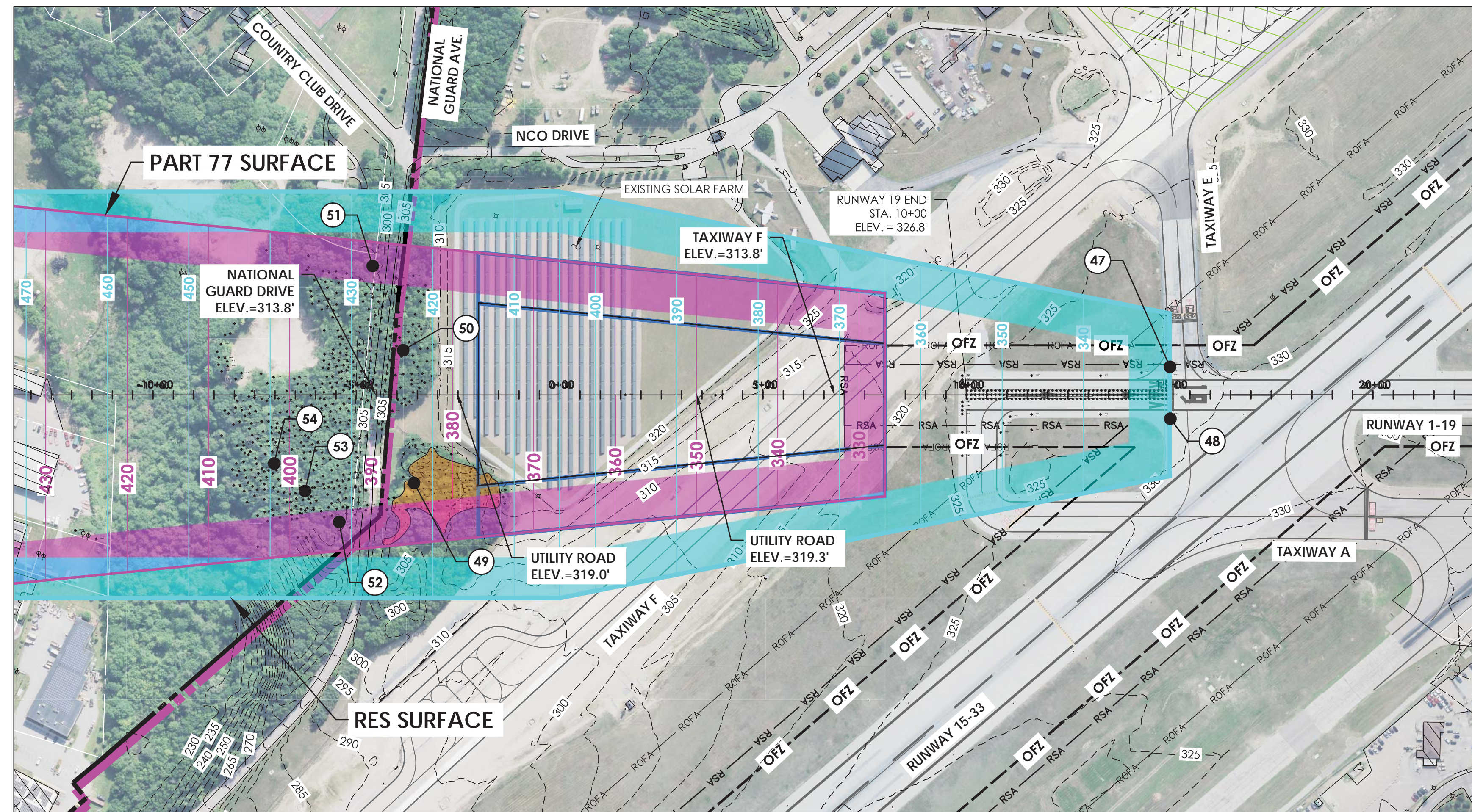

LEGEND:

- AIRPORT PROPERTY LINE
- EXISTING RPZ
- OBSTRUCTION
- TREE CLUSTER



Stamp:

Client:
BURLINGTON INTERNATIONAL AIRPORT
1200 Airport Drive
South Burlington, VT 05403

Passero Associates
242 W. Main Street Rochester, NY 14614 (585) 325-1000 Fax: (585) 325-1691
Principal-in-Charge Andrew Holesko
Project Manager Lisa Chueng
Designed by Wayne Zian

Revisions			
No.	Date	By	Description

UNAUTHORIZED ALTERATIONS OR ADDITIONS TO THIS DRAWING IS IN VIOLATION OF STATE EDUCATION LAW ARTICLE 145 SECTION 7309 AND ARTICLE 141 SECTION 7307. THESE PLANS ARE COPYRIGHT PROTECTED ©

Existing Inner Portion of Runway 19 Approach Surface (Profile)
Airport Layout Plan Update

Burlington International Airport (BTV)
Town/City: South Burlington
County: CHITTENDEN State: Vermont

Project No.
20150403.0002

Drawing No.
10

Date
January 2021

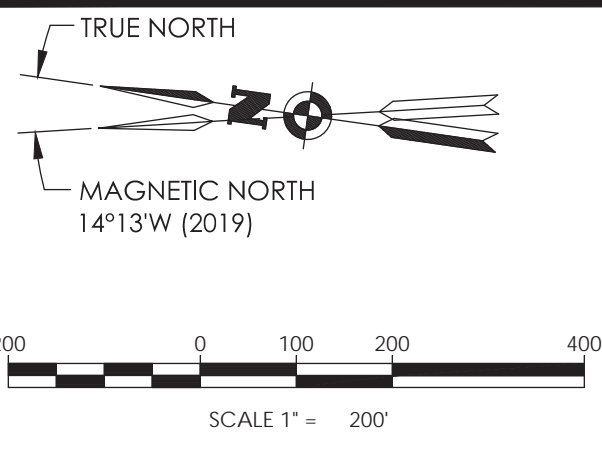

NOTES:

1. OBSTACLE DATA SOURCE, WOOLPERT SURVEY, 2019.
2. "ALL OBJECT ELEVATIONS ARE CURRENT AS OF THIS ALP UPDATE AND ARE SUBJECT TO CHANGE."
3. RES TO BE BASED ON EB99, TABLE 3-2, TYPE 2.

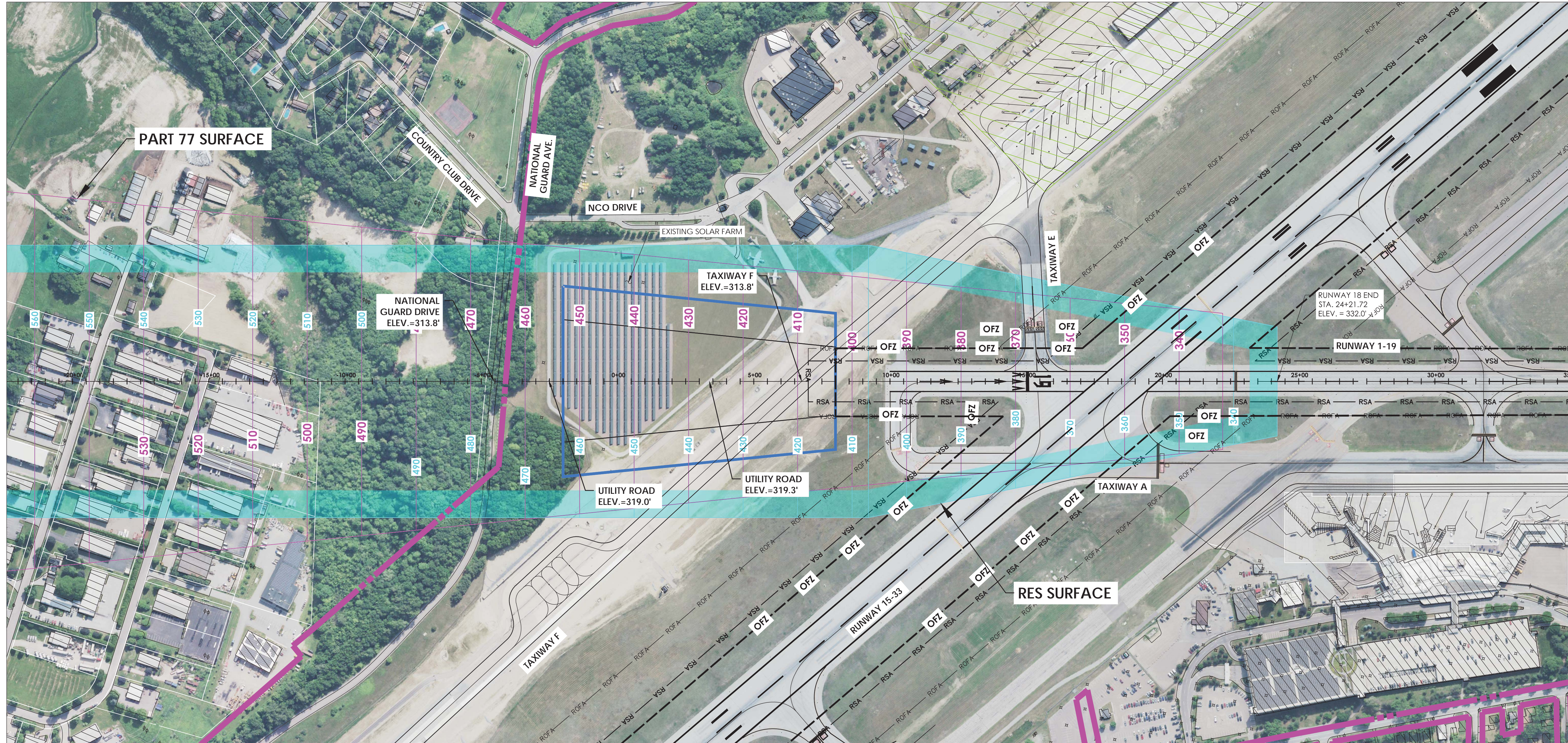

NO OBSTRUCTIONS IN PART 77 AND RES SURFACES

LEGEND:

- AIRPORT PROPERTY LINE
- EXISTING RPZ
- OBSTRUCTION
- TREE CLUSTER

TYPE 2	FROM RUNWAY END	INNER WIDTH	OUTER WIDTH	START DISTANCE	END DISTANCE	SLOPE
RES	0'	250'	700'	2,250'	2,750'	20:1

	FROM RUNWAY END	INNER WIDTH	OUTER WIDTH	DISTANCE	SLOPE
PART 77	200'	500'	1,500'	5000'	20:1



Stamp:

Client:
BURLINGTON INTERNATIONAL AIRPORT
 1200 Airport Drive
 South Burlington, VT 05403

Passero Associates
 242 W. Main Street (585) 325-1000
 Rochester, NY 14614 Fax: (585) 325-1691
 Principal-in-Charge Andrew Holesko
 Project Manager Lisa Chueng
 Designed by Wayne Zian

Revisions

No.	Date	By	Description

UNAUTHORIZED ALTERATIONS OR ADDITIONS TO THIS DRAWING IS IN VIOLATION OF STATE EDUCATION LAW ARTICLE 145 SECTION 7309 AND ARTICLE 141 SECTION 7307. THESE PLANS ARE COPYRIGHT PROTECTED ©

Proposed Inner Portion of Runway 19 Approach Surface (Plan)
 Airport Layout Plan Update

Burlington International Airport (BTV)
 Town/City: South Burlington
 County: CHITTENDEN State: Vermont

Project No.
20150403.0002

Drawing No.
11A

Date
January 2021

LEGEND:

-  AIRPORT PROPERTY LINE
-  EXISTING RPZ
-  OBSTRUCTION
-  TREE CLUSTER

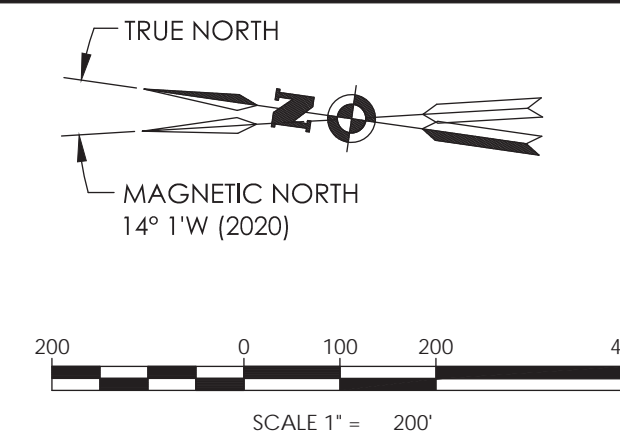

	FROM RUNWAY END	INNER WIDTH	OFFSET' ANGLE	DISTANCE	SLOPE
APPROACH SURFACE (WITH OFFSET)	200'	500'	18.52° (TRUE)	10,000'	20:1

NOTES:

1. OBSTACLE DATA SOURCE, WOOLPERT SURVEY, 2019.
2. ALL OBJECT ELEVATIONS ARE CURRENT AS OF THIS ALP UPDATE AND ARE SUBJECT TO CHANGE.
3. THE EXISTING RUNWAY 1-19 AN OFFSET APPROACH TO THE PART 77 APPROACH.



Stamp:
 Client:
BURLINGTON INTERNATIONAL AIRPORT
 1200 Airport Drive
 South Burlington, VT 05403

Passero Associates
 242 W. Main Street (585) 325-1000
 Rochester, NY 14614 Fax: (585) 325-1691
 Principal-in-Charge Andrew Holesko
 Project Manager Lisa Chueng
 Designed by Wayne Zian

Revisions			
No.	Date	By	Description

UNAUTHORIZED ALTERATIONS OR ADDITIONS TO THIS DRAWING IS IN VIOLATION OF STATE EDUCATION LAW ARTICLE 145 SECTION 7309 AND ARTICLE 147 SECTION 7307. THESE PLANS ARE COPYRIGHT PROTECTED ©

Existing Runway 1 Approach Surface (Side Offset)(Plan)
 Airport Layout Plan Update

Burlington International Airport (BTV)
 Town/City: South Burlington
 County: CHITTENDEN State: Vermont

Project No.
 20150403.0002

Drawing No.
 11B

Date
 January 2021



Stamp:

Client:
BURLINGTON INTERNATIONAL AIRPORT
1200 Airport Drive
South Burlington, VT 05403

Passero Associates
242 W. Main Street (585) 325-1000
Rochester, NY 14614 Fax: (585) 325-1691
Principal-in-Charge Andrew Holesko
Project Manager Lisa Chueng
Designed by Wayne Zian

Revisions			
No.	Date	By	Description

UNAUTHORIZED ALTERATIONS OR ADDITIONS TO THIS DRAWING IS IN VIOLATION OF STATE EDUCATION LAW ARTICLE 145 SECTION 7309 AND ARTICLE 147 SECTION 7307. THESE PLANS ARE COPYRIGHT PROTECTED ©

Existing
Runway 1 Approach
Surface
(Side Offset Profile)
Airport Layout Plan Update

Burlington International Airport (BTV)

Town/City: South Burlington
County: CHITTENDEN State: Vermont

Project No.
20150403.0002

Drawing No.
11C

Date
January 2021

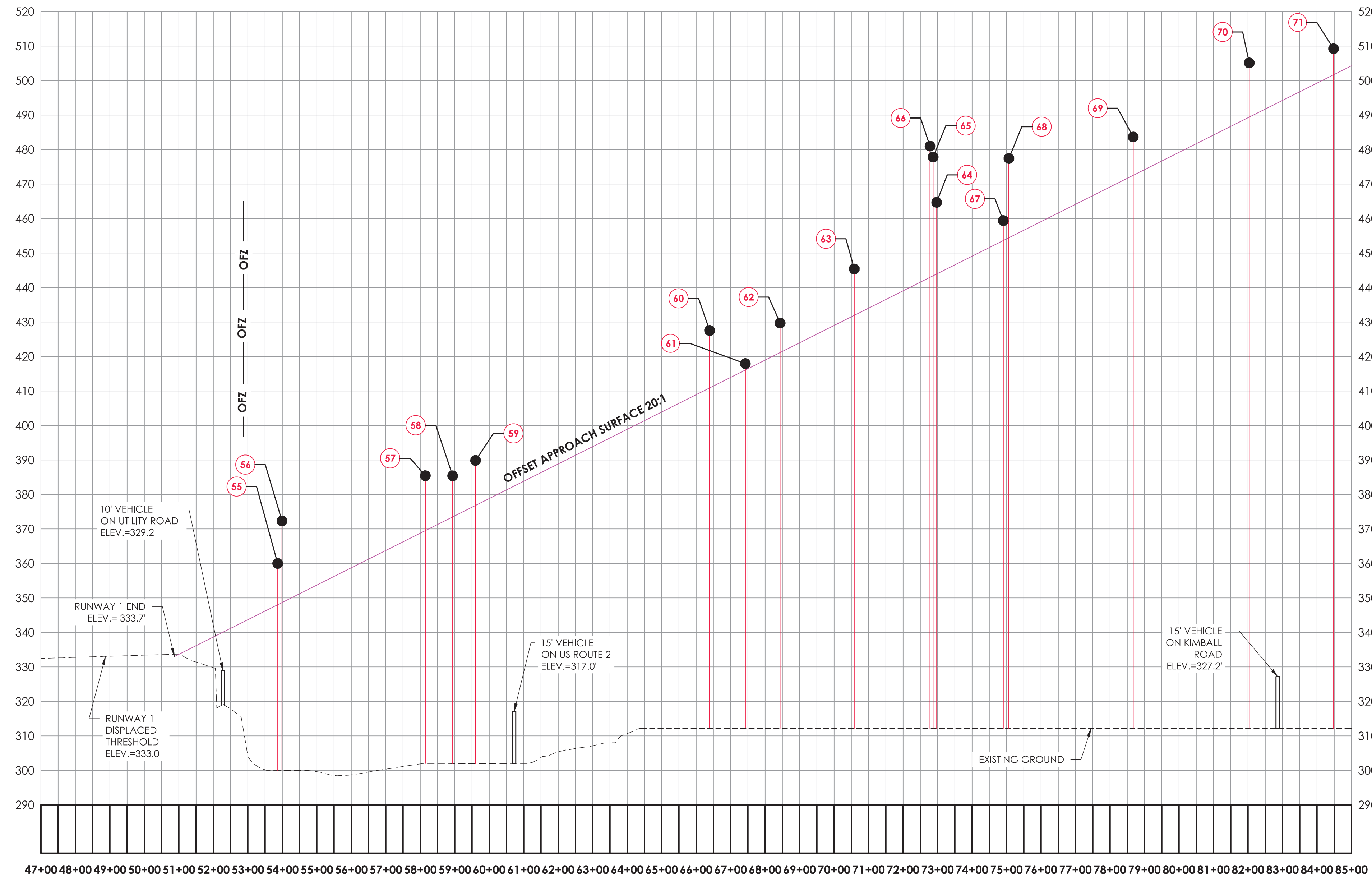

RUNWAY 1 PROFILE
SCALE: HORIZONTAL - 1" = 200'
VERTICAL - 1" = 10'

OFFSET APPROACH SURFACE

ID	DESCRIPTION	OBJECT ELEVATION	SURFACE HEIGHT ALLOWED	20:1 PENETRATION	ON/OFF AIRPORT	DISPOSITION
55	TREE GROUP	360	347.9	12.1	ON	TRIM OR REMOVE
56	TREE	372.3	348.6	23.7	ON	TRIM OR REMOVE
57	TREE	385.4	369.3	16.1	OFF	TRIM OR REMOVE
58	TREE	385.4	373.2	12.2	OFF	TRIM OR REMOVE
59	TREE	389.9	376.9	13	OFF	TRIM OR REMOVE
60	TREE GROUP	417.9	410.5	7.4	OFF	TRIM OR REMOVE
61	TREE	427.5	415.7	11.8	OFF	TRIM OR REMOVE
62	TREE	429.7	421.0	8.7	OFF	TRIM OR REMOVE
63	TREE	445.4	432.0	13.4	OFF	TRIM OR REMOVE
64	TREE	464.7	443.6	21.1	OFF	TRIM OR REMOVE
65	TREE GROUP	477.8	442.1	35.7	OFF	TRIM OR REMOVE
66	TREE	481	442.7	38.3	OFF	TRIM OR REMOVE
67	TREE	477.4	453.2	24.2	OFF	TRIM OR REMOVE
68	TREE	459.4	454.1	5.3	OFF	TRIM OR REMOVE
69	TREE	483.6	471.9	11.7	OFF	TRIM OR REMOVE
70	TREE GROUP	505.1	488.5	16.6	OFF	TRIM OR REMOVE
71	TREE	509.2	501.1	8.1	OFF	TRIM OR REMOVE